

Suggestions for Two Car Garage Layout Plantings

Sample A (Tolerates Full Sun)

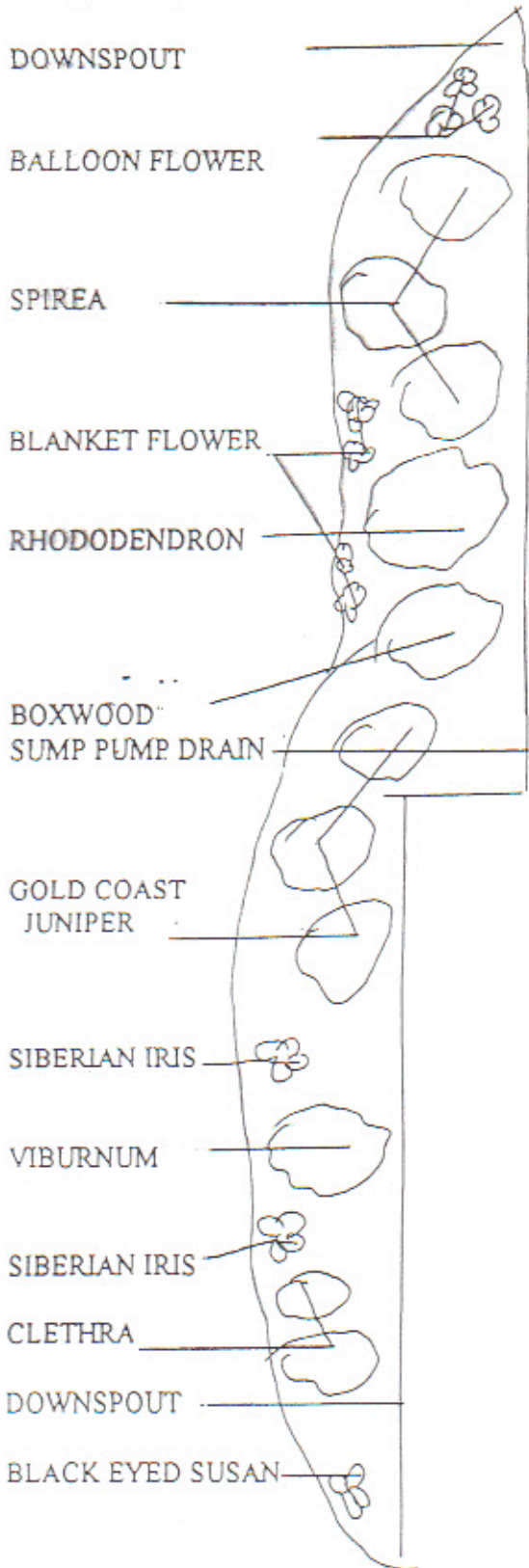

Sample B (Shade Tolerant)

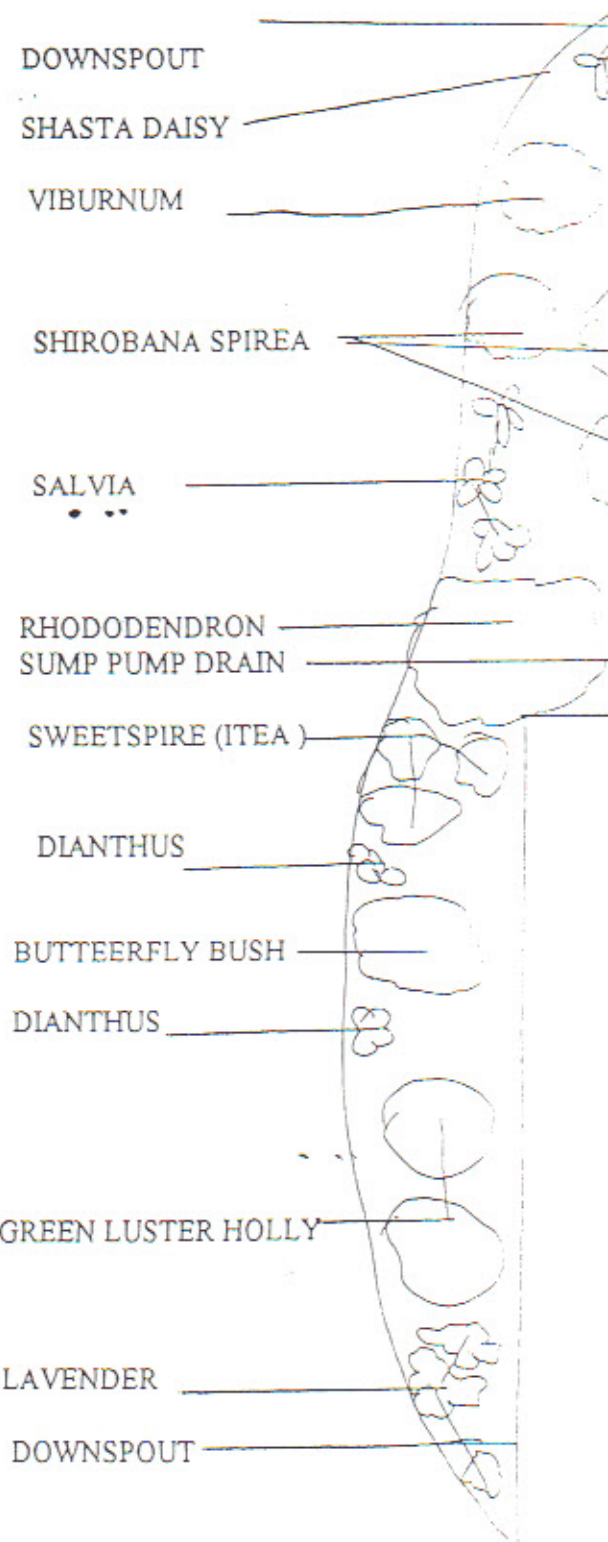

SINGLE CAR GARAGE LAYOUTS

SAMPLE A

TOLERATES FULL SUN

SAMPLE B

SHADE TOLERANT

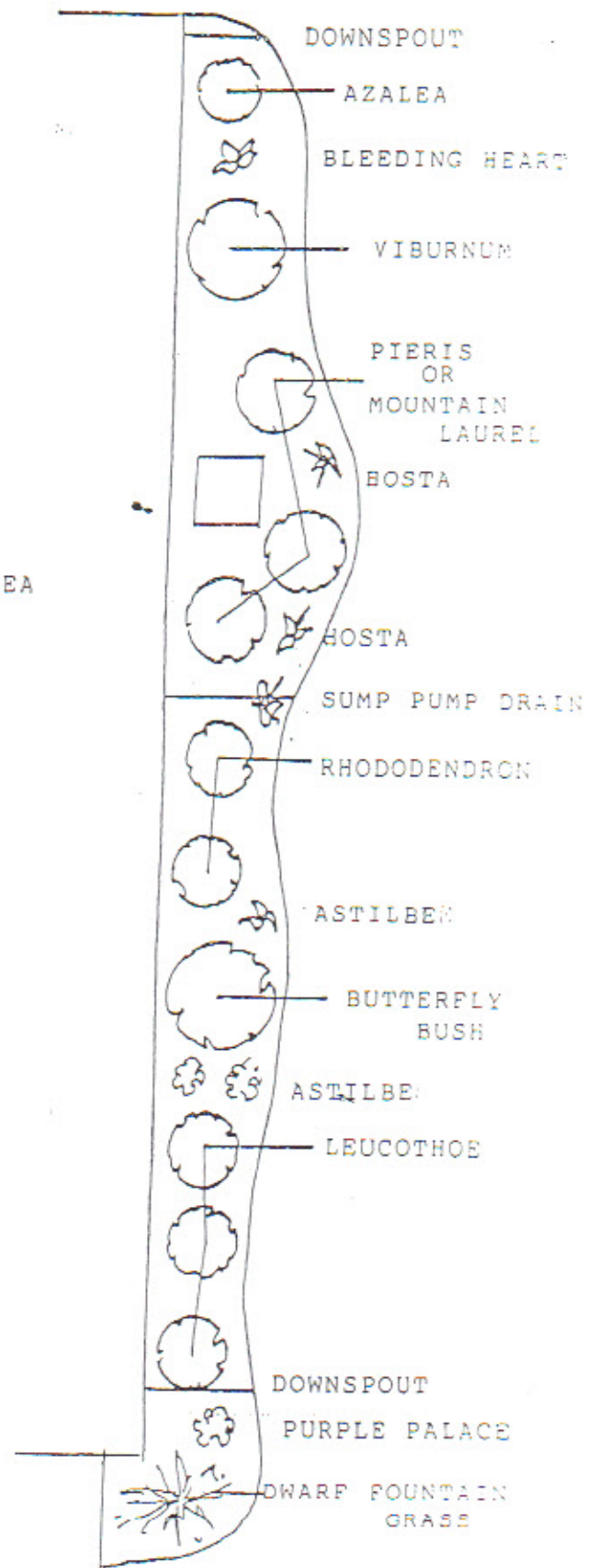
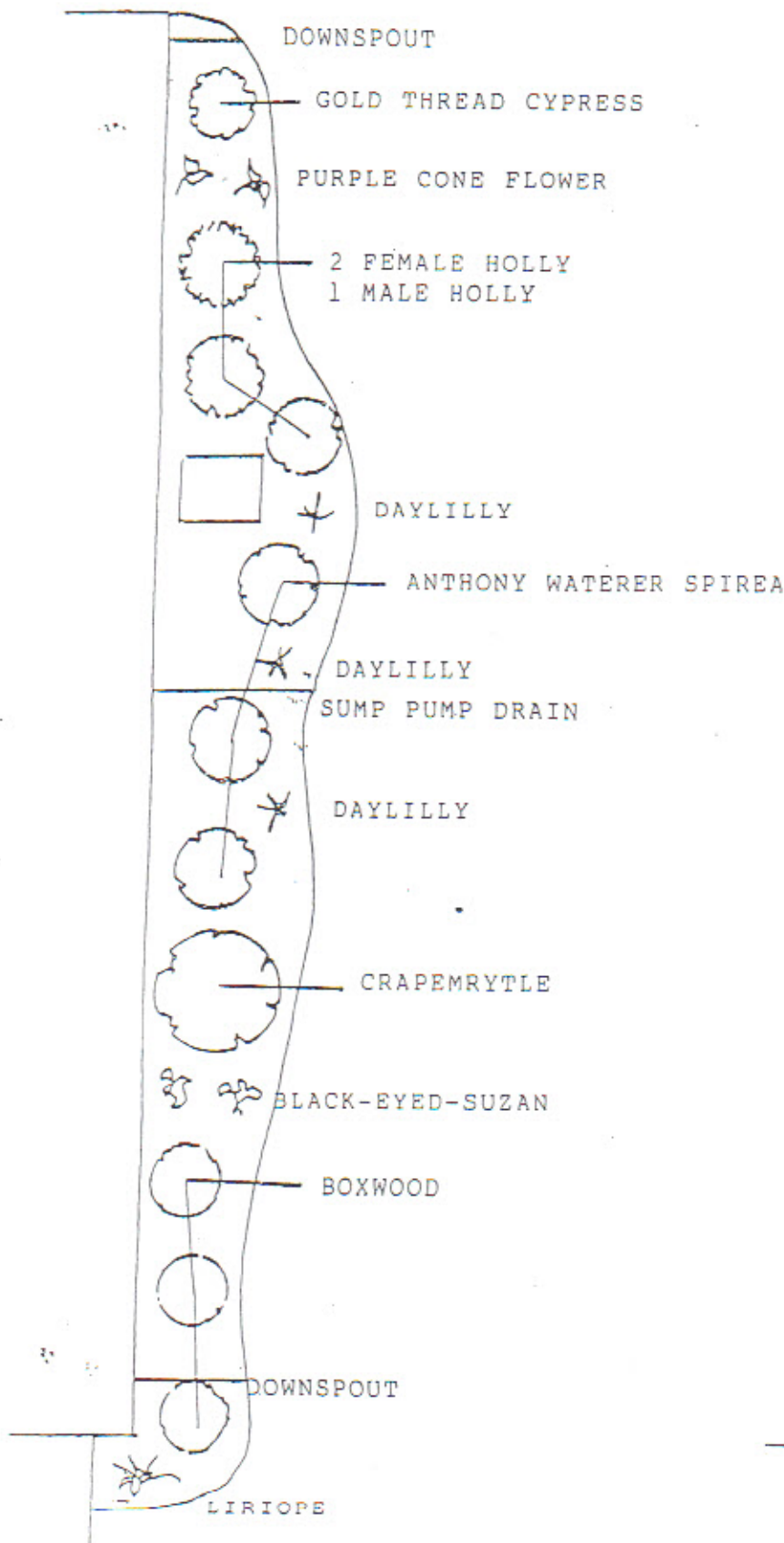

Suggested Shrubs for Mulch Beds

Shrubs/ Evergreen * shade tolerant

Azaleas
Boxwood
Dwarf fountain Grasses
Gold Thread Cypress
Holly Japanese
 Blue Pfitzer
Juniper Gold Coast
 Blue Pfitzer
Leucothoe
Mountain Laurel
Mugo Pines
Pieris Japonica
Rhododendrons
Viburnum evergreen variety

Deciduous * tolerates both sun and shade

Butterfly Bush
Clethra
Crape Myrtle Bush
Lavender
Leucothoe
Lilac Miss Kim
Mountain Laurel (Pieris)
Potentilla
Purple Palace Coral Bells
Scotch Broom
Spireas smaller varieties
Sweet Spirea (Itea)
Viburnum

Suggested perennial flowers

Shade tolerant

Astilbe
Dahlia
Bleeding Heart
Columbine
Coral Bells
Day Lillies
Cranesville Geranium
Hosta Varieties
Liriope
Pachysandra
Siberian Iris

Full sun to part shade

Aster
Balloon flower
Black-eyed Susan (Rudbeckia)
Blanket flower
Butterfly Bush
Cardinal flower
Coneflower
Daylilies
Dead nettle
Delphinium
Dianthus
Iris Siberian/ Bearded
Lavender
Liatris
Peony
Russian Sage
Salvia
Sedum
Shasta Daisy
Dwarf Ornamental Grasses
Yarrow